

ERIS Outdoor

120v : **3-721-xx**

277v : **37-721-xx**

oxygen

FIXTURE TYPE _____

LOCATION _____

PROJECT _____

DATE _____



-16 Gray



-22 Oiled Bronze

LIGHT SOURCE	2 x 8.4W LED, 3000K, CRI 90
LUMINAIRE POWER	20.0W at 120V
RATED LIFE	60000 hr RL
OPTIONAL COLOR TEMPERATURES	2700K, 3500K, 4000K
LUMEN OUTPUT	Delivered: 807 lm (LM-79)
INPUT VOLTAGE	120V or 277V
DRIVER OUTPUT	2 x 350 mA, 12W
DIMMING	0-10v & Phase (ELV) Dimming - 50/60Hz 100% to 10% Dimming
CONSTRUCTION	Cast Aluminium and Glass
DIFFUSER	- Frosted Glass
FINISHES	Gray (-16), Oiled Bronze (-22)
MOUNTING	4" Octagonal J-Box*, 4" Squared J-Box* *Deep J-Box (Installer must provide a bead of caulk between fixture housing and mounting surface)
STANDARDS	ETL Wet, Conforms to UL STD 1598, Certified CAN/CSA, STD C22.2 No 250.0.

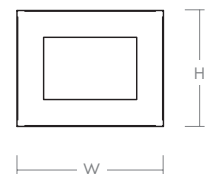
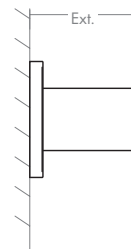
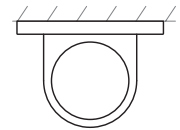

DIMENSIONS

W: 6.00"

H: 4.75"

Ext: 4.35"

M.C: 2.37" From top of fixture

Order example for standard fixture:

3-721-22 (x- Voltage - xxx-Sequence # - xx-Finish)

3: 120v, **37:** 277v

Order example for optional color temperatures: **3-721-2722**

27: 2700K, **35:** 3500K, **40:** 4000K

